

MSWCA Conference



HINDS COMMUNITY COLLEGE / MISSISSIPPI COLLEGE

March 22-23, 2019

Table of Contents

Schedule of Events p. 3
Session A p. 4
Keynote Address..... p. 11
Session B p. 12
TutorCon & Admin Breakouts..... p. 21
Session C p. 22
Closing Remarks p. 29
Hinds CC Map..... p. 30
MC Map..... p. 31
Anderson Hall Map p. 32
Fun Things to do in Jackson/Clinton p. 33
Special Thanks..... p. 34

• • • • •
•
• **Wifi:** •
• network: MC Guest •
• password: vuwrisli •
•
• • • • •

Schedule of Events

Friday, March 22, 2019 at Hinds Community College

McLendon Library, Room 222A

5:00-5:30 PM	Welcome & Refreshments
5:30-6:30 PM	Mix & Mingle Activity
6:30-7:30 PM	MSWCA Board Meeting

Saturday, March 23, 2019 at Mississippi College

Anderson Hall

8:00 AM - 4:00 PM	Registration
	Welcome and Introduction: <i>Lingshan Song</i>
8:30 - 8:50 AM	Welcome Address: <i>Dr. Ron Howard, Provost</i>
9:00 - 10:15 AM	Concurrent Session A
10:30 - 11:45 AM	Keynote: <i>Dr. Jackie Grustch McKinney</i> <i>from Ball State University</i>
11:50 AM -12:50 PM	Lunch
1:00-2:15 PM	Concurrent Session B
2:30-3:45 PM	TutorCon & Admin Breakouts
4:00-5:15 PM	Concurrent Session C
5:30-5:50 PM	Closing Remarks: <i>Kathleen Hutchinson</i>

Board Meeting Room (Panel Presentation)

Better Together?—Successes and Challenges in Fostering Cross-Campus Partnerships at MSU

Meeting Room A (Roundtable Discussion)

Reflecting (on) Audience: A Conversation among Tutors

Meeting Room B (Individual Presentations - 20 minutes each)

A-1: Corridor Composition: Collaborative Poetry at Hinds JATC

A-2: Collaborative Reading in College Writing Centers

A-3: Citizen, Connection, and Collaboration: Understanding Diversity in Jackson's Writing Centers

Better Together?—Successes and Challenges in Fostering Cross-Campus Partnerships at MSU



Kayleigh Few, Sava Kolev, Loree Long

Mississippi State University

This presentation will discuss different collaborations The MSU Writing Center has attempted with other campus units and examine both the success and failures of each one. Our goal is to not only share the partnerships we've been able to establish but to reflect on what makes collaboration effective and sustainable. We will conclude by inviting the audience to share their experiences with cross-campus partnerships as a way to brainstorm other avenues to explore for outreach.

Reflecting (on) Audience: A Conversation among Tutors

Samuel Lewis, Mya Lee, David Camper, Tyler Hurley 

Jackson State University

Participants in this roundtable will engage in a conversation about tutor training readings and strategies that have worked for them to increase collaboration and to share how they approach rhetorical awareness in their sessions. They will discuss the roles collaboration and conversation play in their tutorial sessions, and how these increase rhetorical awareness and understanding for writers, including themselves.

Corridor Composition: Collaborative Poetry at Hinds JATC



Bethany Kinney

Hinds Community College

This presentation will discuss the continuous collaborative poetry efforts undertaken by the writing center at the Hinds Community College Jackson Academic/Technical Center. The purpose of this project is to foster an attitude of collaboration and creative freedom in the writing center. I will review insights gained about the collaborative process, both student and employee responses to the project, and the works of creative writing which have been generated.

Collaborative Reading in College Writing Centers

Christine Anderson, Katherine Parker 

Mississippi College

This presentation will offer a new way to actively bridge the gap between reading and writing in the writing center by engaging the help of both tutors and students. Our goal is to purposefully provide more opportunities for tutors and students to not only read but critically engage with some of their favorite texts while sharing their favorite books. We will conclude by offering collaborative engagement to connect reading to writers in writing centers statewide.

Citizen, Connection, and Collaboration: Understanding Diversity in Jackson's Writing Centers

 *Cailey Ness, Morgan Moss*

Millsaps College

Perhaps the most insidious and least understood form of segregation is that of the word.” Claudia Rankine, *Citizen: An American Lyric* Inspired by Rankine’s *Citizen*, undergraduate tutors at a privileged and predominantly white SLAC in Jackson, Mississippi, investigate diversity by evaluating how we enact connection and collaboration. We must examine ourselves and our neighbors to better understand minority students—the expectations they have from writing centers, and the roles they can play within them.

Keynote Address

Anderson Hall West

10:30-11:45 AM

 **Dr. Jackie Grustch McKinney**

Ball State University

Board Meeting Room (Panel Presentation)

Alone Together: the Challenges of Online Tutoring

Meeting Room A (Roundtable Discussion)

But You Have to Go!: The Collaborative Success of Mandatory Visits

Meeting Room B (Individual Presentations - 20 minutes each)

B-1: Are You My Neighbor? Building Connections between Mississippi's Writing Centers

B-2: Using Multimodal Tutoring Practices to Promote Connection and Inclusion in the Writing Center

B-3: Extending Our Research: Meta-Analysis in the Writing Center

Anderson Hallway (Poster Presentation)

The Writing Center Glossary: A New Way to Research Collaboration in the Writing Center

Alone Together: the Challenges of Online Tutoring

 **Murray Shugars**

Alcorn State University

This panel addresses the Alcorn Writing Center's current effort to pilot an online tutoring capability. Participants will discuss the challenges and successes of making and maintaining digital connections and collaborations. The panel represents the perspectives of a writing center director / administrator and a team of undergraduate writing consultants. Participants will share firsthand experiences grounded in the published discourse of writing center theory and practice.

But You Have to Go!: The Collaborative Success of Mandatory Visits

Logan Brauer, Alexis Lunsford, Elizabeth Jones, Joshua Figures 

Northwest Mississippi Community College

In this presentation, we will examine the positive aspects of mandatory appointments and how collaborative endeavors enhance student efficacy and support student success. We will discuss how our Quality Enhancement Plan (QEP) has helped shape positive perceptions of the writing center, as well as, encourage students to understand the writing center's value.

Are You My Neighbor? Building Connections between Mississippi's Writing Centers



Liz Egan and Millsaps Writing Consultants

Millsaps College

No writing center is an island...or is it? It is easy to default to the community formed within the borders of one's own institutional community, but how might we connect and collaborate with the centers that are our neighbors? By mapping out active writing centers in the state, we begin to see opportunities as well as obstacles for intrastate interaction among writing centers in Mississippi on the basis of geographical proximity and shared identities.

Using Multimodal Tutoring Practices to Promote Connection and Inclusion in the Writing Center

Leah Gutenson, Jennifer Alford 

Hinds Community College

This presentation will locate multimodal writing processes in the context of writing center best practices. The co-presenters, an ASL interpreter and a writing center director, will explore practical strategies for incorporating multimodal writing processes of into sessions with clients. Ultimately, the purpose of this presentation is to invite conversation between the speakers and the audience members about the way(s) multimodal writing processes might be encouraged in the writing center to promote connection and inclusion.

Extending Our Research: Meta-Analysis in the Writing Center

 *Steve Price*

Mississippi College

Too often, writing center administrators avoid research due to a lack of time or a perceived lack of training. Meta-analysis is an emerging writing center research method that we all can utilize. This presentation will define meta-analysis, offer examples from writing center studies, and introduce audience members to strategies and resources they can use in their own writing centers.

The Writing Center Glossary: A New Way to Research Collaboration in the Writing Center

Jessica Herron 

Northwest Mississippi Community College

The Writing Center Glossary is a proposed supplementation for peer tutoring training in the writing center. It not only promotes collaboration among peer tutors as they collectively author it, but it also poses a way to store those collaborative efforts so that tutors can reference it later. Thus, the Writing Center Glossary is a tool that can research the effects of collaborative peer coaching on peer tutor training in the writing center.



TutorCon & Admin Breakouts

TutorCon: Board Meeting Room

Admin: Meeting Room A

2:30-3:45 PM

Board Meeting Room (Panel Presentation)

How to Conduct a Productive Norming Session with your Staff

Meeting Room A (Roundtable Discussion)

Grappling with Conflicting Narratives: Questions for Our State

Meeting Room B (Individual Presentations - 20 minutes each)

C-1: Tutor's Perspectives on Online Tutoring

*C-2: The "Whiting Center": Combatting Colonial Imperatives in Academia
in the Twenty-First Century*

C-3: The Use of Outlines at the Mississippi College Writing Center

How to Conduct a Productive Norming Session with your Staff

 **Rachel Johnson**

University of Mississippi

This workshop is directed at WC directors and administrators. Participants in this workshop will learn about the benefits of and receive practical guidelines for conducting a norming training session with tutorial staff. The workshop will model a writing tutorial norming session and the presenter will share resources and tools for multiple configurations of the activity. Participants can expect to leave the session with a “toolkit” of sorts for customizing the activity for their own professional and institutional context.

Grappling with Conflicting Narratives: Questions for Our State

Kathi Griffin, Tatiana Glushko 

Jackson State University

In this roundtable we would like to discuss the grand narratives that researchers like Harry Denny, John Nordlof, and Lori Salem (2018) are calling to question, how the teaching of composition and the work of writing centers locally align with or run counter to those narratives, and what we might learn from developing “microhistories” from the view of writing centers in Mississippi.

Tutor's Perspectives on Online Tutoring



Sydney Nicholson, Isaac Jackson

Mississippi College

This presentation will discuss different patterns of reported perspectives that the MC Writing Center tutors have on online tutoring. Our goal is to share with other writing centers how MC tutors view online training, and to address the reasons tutors cite for why they have or have not become online tutors. In our conclusion, we will discuss ways in which writing centers can use this information to expand and improve their own online tutoring services.

The “Whiting Center”: Combatting Colonial Imperatives in Academia in the Twenty-First Century

Allison Wiltshire 

Mississippi State University

In this essay, I revisit “Postcolonialism and the Idea of a Writing Center” (1999), in which Anis Bawarshi and Stephanie Pelkowski discuss the Writing Center as an extension of an academic system that insists upon “white language” as the solely correct standard for academic English writing. I challenge Bawarshi and Pelkowski’s push for a Writing Center that mutually respects indigenous cultures and “proper” academic writing standards, and I argue that Bawarshi and Pelkowski’s vision of the postcolonial Writing Center can be achieved only through a critically conscious and visible subversion of an academic system that prioritizes whiteness.

The Use of Outlines at the Mississippi College Writing Center



Cassandra Holcombe

Mississippi College

Writing centers are built on collaboration between tutors and tutees, but it can be a real challenge decide when to contribute and when the tutee should work without further assistance. In my experience, a tool that can help tutors in these situations is outlining. But are outlines effective in helping the tutee? Are they used a lot by tutors? This presentation will show the data behind the use of outlines at the Mississippi College Writing Center.

Closing Remarks

Anderson Hall West

5:30-5:50 PM



Kathleen Hutchinson

Mississippi College



RAYMOND CAMPUS

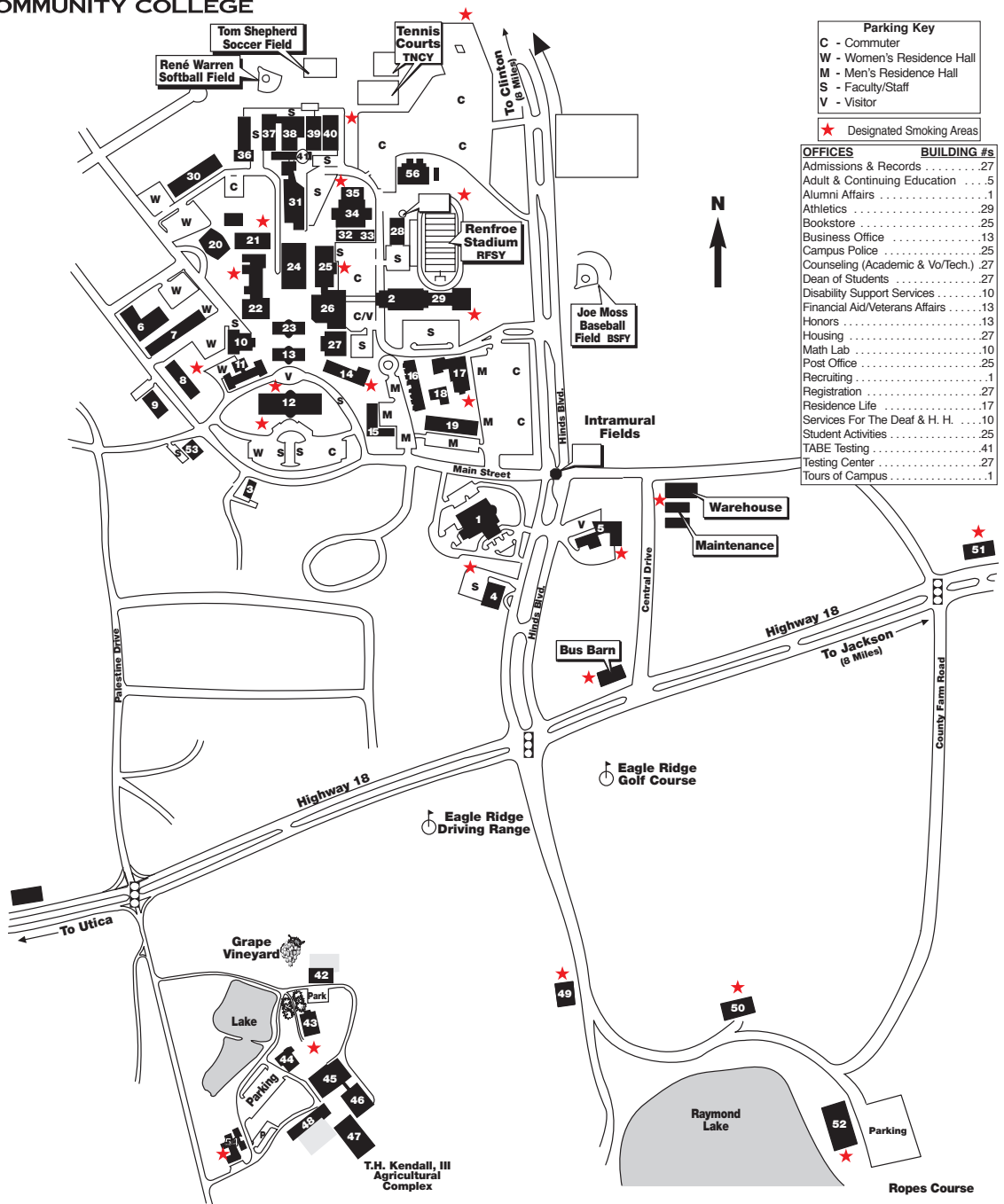

Parking Key	
C	- Commuter
W	- Women's Residence Hall
M	- Men's Residence Hall
S	- Faculty/Staff
V	- Visitor
★	- Designated Smoking Areas

OFFICES	BUILDING #s
Admissions & Records	27
Adult & Continuing Education	5
Alumni Affairs	1
Athletics	29
Bookstore	25
Business Office	13
Campus Police	25
Counseling (Academic & Vo/Tech)	27
Dean of Students	27
Disability Support Services	10
Financial Aid/Veterans Affairs	13
Honors	13
Housing	27
Math Lab	10
Post Office	25
Recruiting	1
Registration	27
Residence Life	17
Services For The Deaf & H. H.	10
Student Activities	25
TABE Testing	41
Testing Center	27
Tours of Campus	1

A.L. Denton Hall- DNHY	27	Hardy-Purveyer Residence Hall- HPRY	6	Stadium Building- SBY	28
Accounting Offices	9	Harris Patrick Hall- HPHY	23	Student Union Building- SUBY	25
Adam Jenkins Jr. Hall	13	Herrin-Stewart Hall- HSHY	14	Troy Arlis Ricks Wellness Complex	2
Agriculture Arena- AARY	45	Human Resources- HRY	53	Vashti Underwood Muse Band Hall	56
Allen-Dukes-Whitaker Residence Hall	8	Interpreter Services- DSBY	10	Veterinary Tech- VETY, Landscape Management Shop	42
Bee Hall- BHY	21	Katherine Denton Art Building- DABY	35	Vo-Tech Complex- (Business & Office- A101,	
Beemon Hall- BMHY	22	Landscape Management Building- LMV	43	Computer Prog-A103, Related Studies-A110)-VTAY	41
Brooks Hall- BRHY	32	Marshall Residence Hall- MRHY	7	Vo-Tech Complex-(Graphic Design-B100, Offset Printing-B102,	
Brooks Theatre- THEA in BRHY	33	Mayo Fieldhouse- MFHY	29	Carpentry-B103, Brick Msry-B106)-VTBY	40
Bull Test Center- BTCY	48	McKenzie Arena- MKAY	44	Vo-Tech Complex- (Computer Prog- C100, Communication	
Cafeteria- CFTY	26	McLendon Library/Media Center- MCLY	24	Elec Repair- C102, Electrical- C104)- VTCY	39
Cain-Cochran Hall- CCHY	12	Moss Hall- MHY	10	Vo-Tech Complex- (Heating & Air Condng- D102,	
Central MS Research and Extension Center-MSU	54	Physical Plant- PPAY	3	Communication Elec. Repair- D105)- VTDY	38
D.G. "Sonny" Fountain Hall	1	Pickett Hall (Old Main Women's Residence)- PKHY	11	Vo-Tech Complex- (Machine Shop- E103 &	
Davis Residence Hall- DVHY	20	Porter Hall- (Meat Merchandising)- PHY	4	Welding-E107)- VTEY	37
Diesel Equipment (Gray Partridge Center)- GPCY	51	Raymond Lake Lodge- LDGY	50	Vo-Tech Complex- (Auto Machinist- F100,	
District Adult Education Center	5	Reeves Hall- RHY	34	Auto Electronics- F102, Auto Mechanics- F104)- VTFY	36
Eagle Ridge Conference Center- ERCY	52	Riggs-Virden Residence Hall	19	Vo-Tech Complex- (Auto Vehicles & Accessories Mkt- G100,	
Eagle Ridge Golf Pro Shop- GPS	49	Sale Barn/Arena- SLBY	47	Collision Repair- G102)- VTGY	30

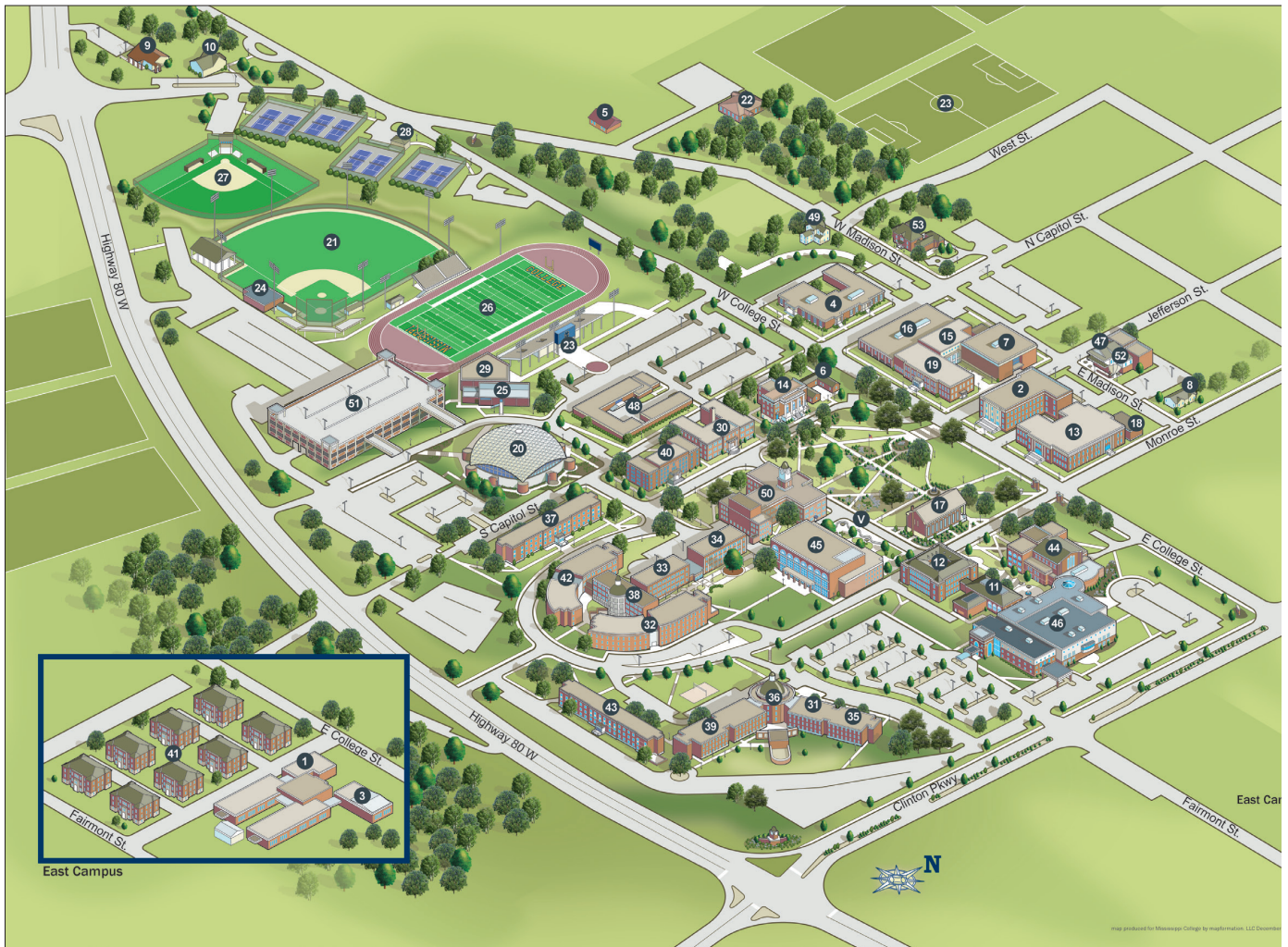

ACADEMIC BUILDINGS

1. Art Annex
2. Aven Fine Arts Building
3. Band Hall
4. Cockroft Hall
5. Dyslexia Center
6. Farr Hall
7. Hederman Science Building
8. International Center East
9. International Center West A
10. International Center West B
11. Jennings Annex
12. Jennings Hall
13. Leland Speed Library
14. Lowrey Hall
15. Math, Chemistry, Computer Science
16. Medical Sciences Building
17. Provine Chapel
18. Samuel Marshall Gore Art Galleries
19. Self Hall

ATHLETIC FACILITIES

20. A.E. Wood Coliseum
21. Frierson Field
22. Girling Fieldhouse
23. Longbaugh Field
24. Rice Field House
25. Moody Adams Field House
26. Robinson-Hale Stadium
27. Softball Complex
28. Tennis Clubhouse
29. Williams Strength Center

RESIDENCE HALLS

30. Chrestman Hall
31. Cockroft-Caldwell Hall
32. East Tower
33. Gunter Hall
34. Hederman Hall
35. Hitt-McCullough Hall
36. Holloway Rotunda
37. Latimer-Webb Hall
38. Mary Nelson Hall
39. Quick Hall
40. Ratliff Hall
41. University Place
42. West Tower
43. Whittington Hall

OTHER BUILDINGS

44. Alumni Hall
45. B.C. Rogers Student Center & Anderson Hall
46. Baptist Healthplex
47. Bookstore
48. Lanier Physical Plant
49. Latimer House
50. Nelson Hall/Swor Auditorium
51. Parking Garage
52. Pimento's Cafe
53. Phillips House

MAIN SWITCHBOARD

601.925.3000

Undergraduate Admissions601.925.3800
Nelson Hall, Basement

Business Office601.925.3307
Nelson Hall, 1st Floor

Financial Aid601.925.3212
Nelson Hall, Basement

Public Safety601.925.3204
Alumni Hall, 1st Floor, Room 102



Mississippi College

A CHRISTIAN UNIVERSITY

Map of Anderson Hall

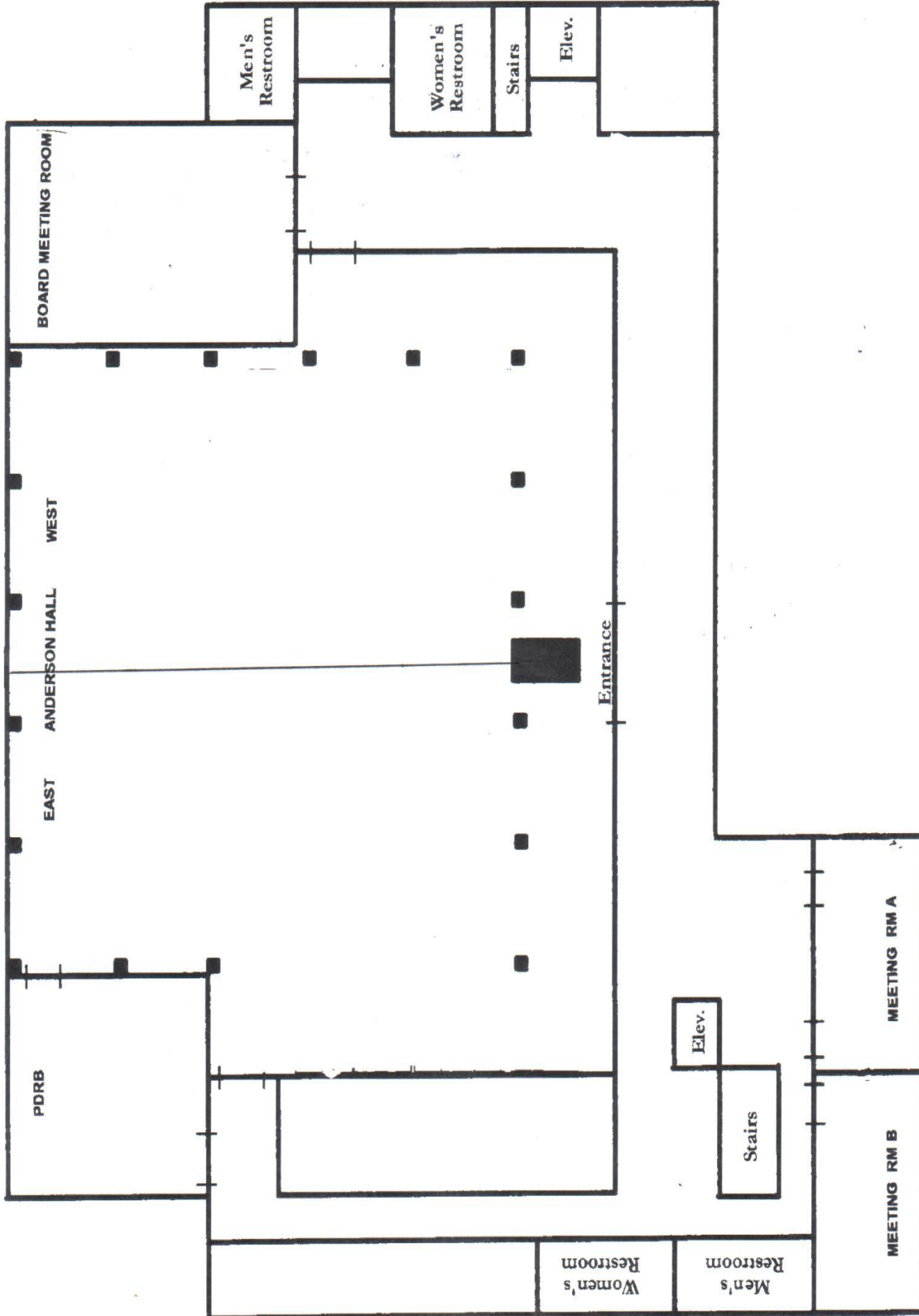

Fun Things to do in the Jackson/Clinton Area!

Activities

Jackson

Mississippi Civil Rights Museum
Mississippi Museum of Art
Eudora Welty House and Gardens
The Jackson Zoo
Lemuria Books



Clinton

Funtime Skateland
Wyatt Waters Gallery
Traceway Park
[Historic Sites on the Natchez Trace]
Indian Lanes
Nature Center

Restaurants



Jackson

Babalu's Tapas & Tacos
The Pig & Pint
Sal & Mookie's New York Pizza
Keifer's Restaurant
Brent's Drugs

Clinton

Froghead Grill
Bonsai Japanese Steak House
303 Jefferson
Salsa's Mexican Restaurant
The Bank
Fuzzy's Taco Shop
Cups
Meme's Brick Street Bakery

Special Thanks To



Mississippi
College

A CHRISTIAN UNIVERSITY



SWCA
Southeastern Writing Center Association

Special Thanks To

Hinds Community College

- Dr. Ben Cloyd, Academic Dean of the Raymond Campus
- Mary Beth Applin, District Dean of Learning Resources
- Melissa Buie, Chair of the English & Foreign Languages Department
- Jennifer Todd, Circulation Librarian
- Julie Clark, Instructional Designer

Mississippi College

- Dr. Blake Thompson, MC President
- Dr. Ron Howard, Vice President of Academic Affairs
- Mrs. Kathleen Hutchinson, Director of MC Leland Speed Library
- Dr. Jackie Grustch McKinney, IWCA President & Conference Keynote Speaker
- Mrs. Laura Ann Hoffman, MC Event Services Director
- Dr. Steve Price, MC Writing Center Director
- Dr. Kerri Jordan, MC Writing Program Faculty
- Dr. Kristi Melancon, MC Writing Program Faculty
- Mr. Daniel White, MC Writing Program Faculty
- Samantha Dean, Conference Chair Assistant
- Sophie Abuzeid, Conference Logo & Program Designer

Proposal Reviewers

- Kathi Griffin (Jackson State University)
- Tatiana Glushko (Jackson State University)
- Liz Egan (Millsaps University)
- Kayleigh Few (Mississippi State University)

